

# SAVE VSR 150/B

## Replacing rotor drive belt

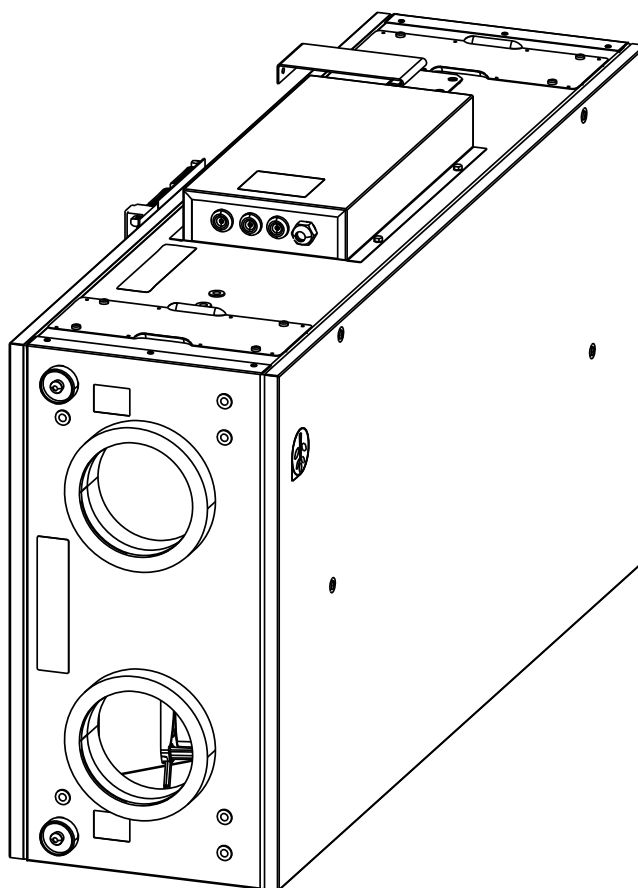

### Replacement instructions

## Contents

1 Warnings.....	1
2 General.....	1
3 Replacing rotor drive belt.....	2

# 1 Warnings

The following admonitions will be presented in different sections of the document:

## **Danger**

- Make sure that the mains supply to the unit is disconnected before performing any maintenance or electrical work!
- All electrical connections and maintenance work must be carried out by an authorized installer and in accordance with local rules and regulations.

## **Warning**

- The system should operate continuously, and only be stopped for maintenance/service.
- The installation of the unit and complete ventilation system must be performed by an authorized installer and in accordance with local rules and regulations.
- Beware of sharp edges during mounting and maintenance. Use protective gloves.
- All though the Mains supply to the unit has been disconnected there is still risk for injury due to rotating parts that have not come to a complete standstill.
- This product must only be operated by a person which has suitable knowledge or education within this field or carried out with the supervision of a suitably qualified person.
- Risk of personal injury! The heat exchanger is heavy. There is a risk that the heat exchanger falls out of the unit.
- Make sure that small children are not beneath the unit when the heat exchanger is removed!

# 2 General

This installation manual concerns air handling unit type SAVE VSR 150/B manufactured by Systemair AB.

The manual consists of basic information and recommendations concerning installation of a new rotor drive belt. The new rotor drive belt is delivered in a plastic bag with the manual and a nipple that can be attached to the belt in order to fix it.

The key to proper and safe replacement of the rotor drive belt is to read this manual thoroughly, use the unit according to given guidelines and adhere to all safety requirements.

## 3 Replacing rotor drive belt

### **Warning**

If the unit is ceiling mounted with side cover facing downwards, the heat exchanger may fall out if not secured.

**1**

Disconnect the unit from the mains supply.

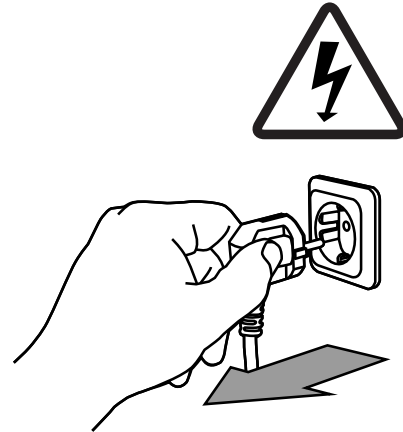

**2**

Loosen four screws to open the side cover.

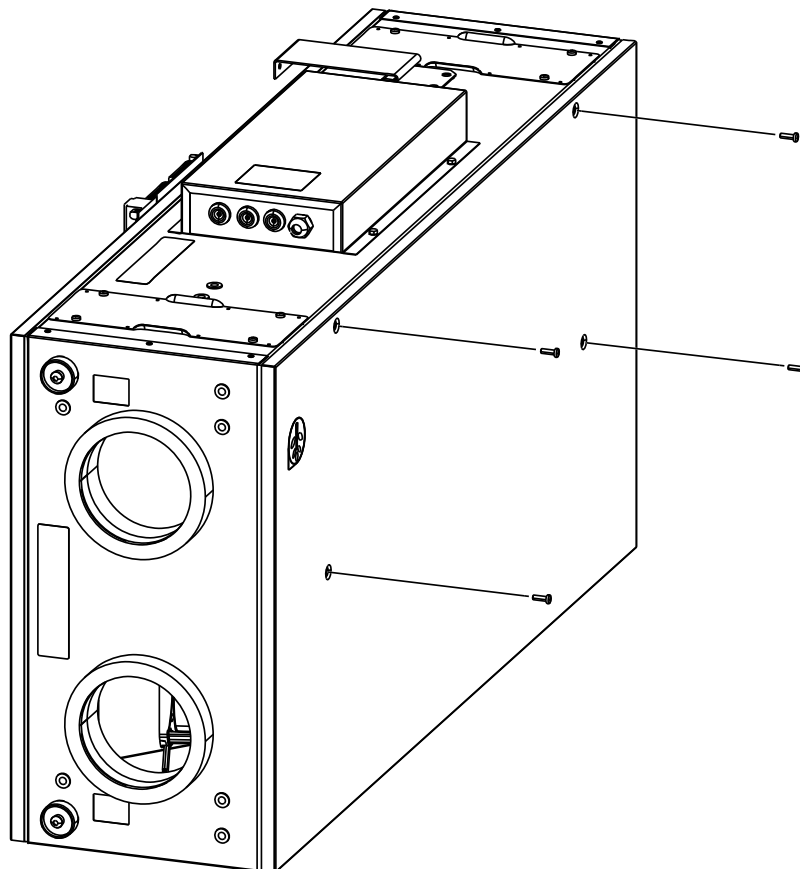

3

Open the side cover.

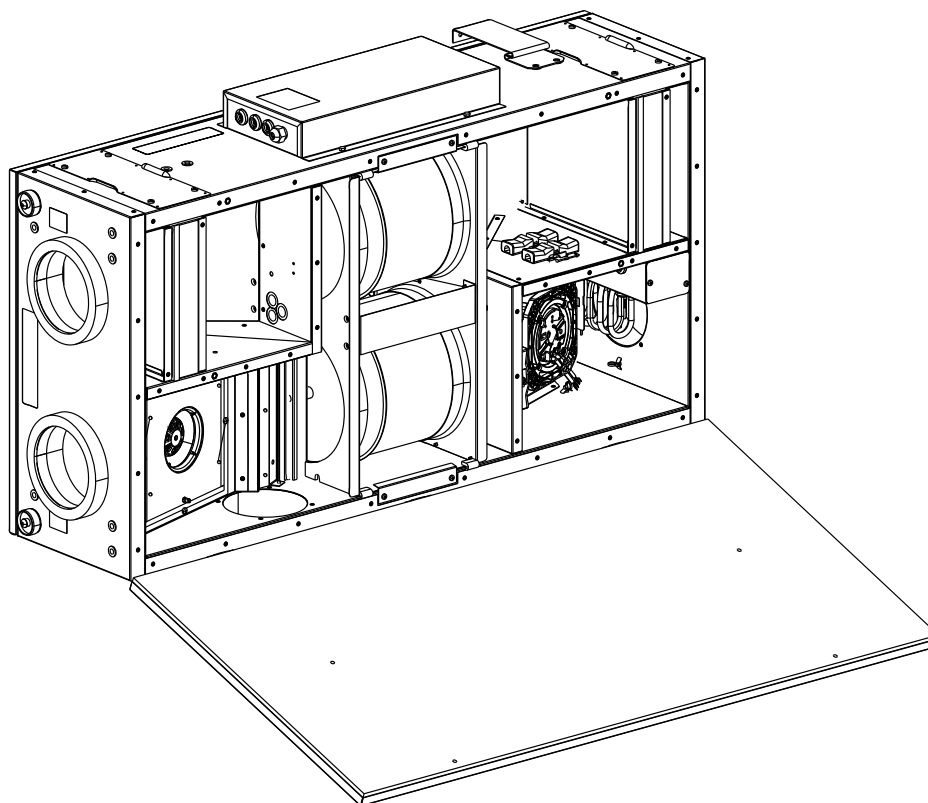

4

Disconnect the heat exchanger quick release connections.

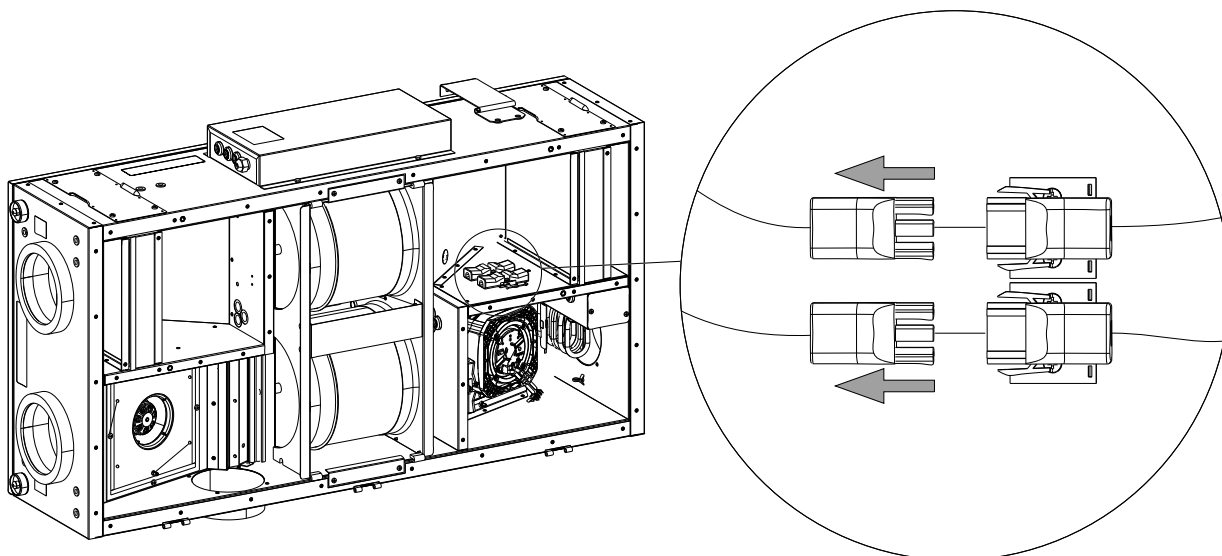

# Note:

If quick release connections are not visible, then they are behind the filter in the extract air chamber (pos 4).

Remove bracket holding screws (pos 1), remove the bracket (pos 2) and pull out the filter (pos 3), then disconnect quick release connections in the extract air chamber (pos 4).

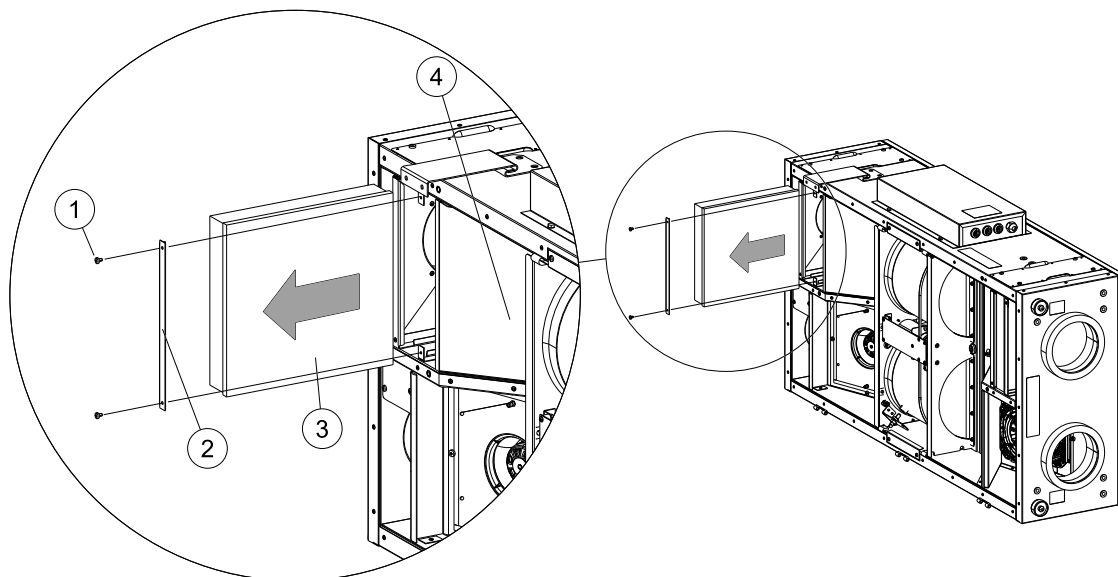

5



## Warning

- If the unit is mounted with a side cover facing downwards, do not remove the screws in the slots. They will prevent the heat exchanger from falling out accidentally.
- Make sure that small children are not beneath the unit when the heat exchanger is removed!

Remove two brackets (pos 2) that hold the heat exchanger package by loosening 4 screws (pos 1).

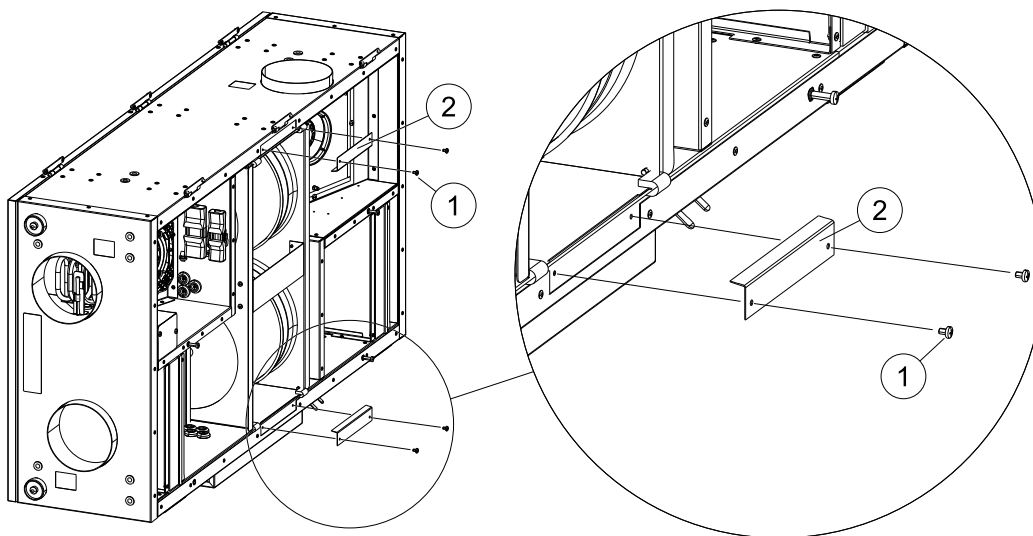

6

Take out the heat exchanger package. Remember its position.

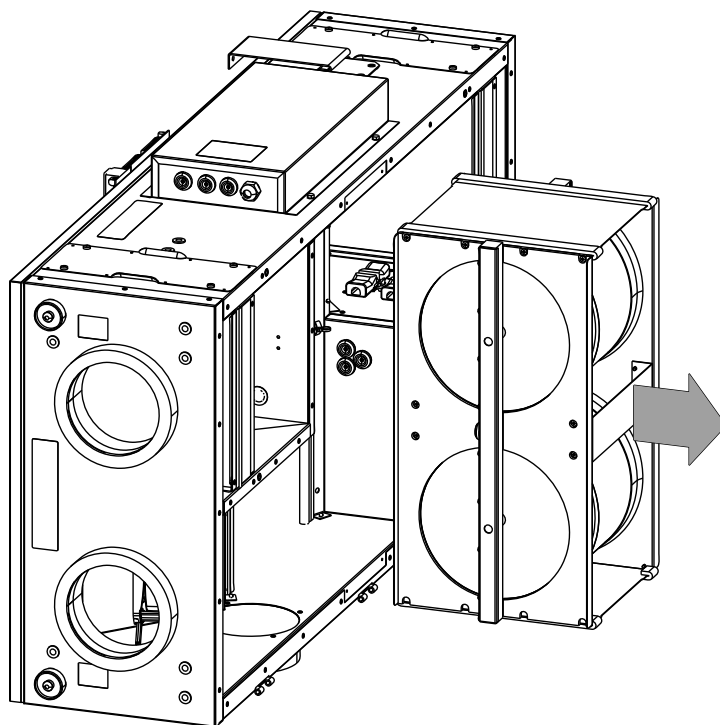

7

Place the heat exchanger on the flat secure surface with the rotor drive facing top. Remove 8 screws at the front and 4 screws at the back and then 2 screws holding heat exchangers in order to remove side casing.

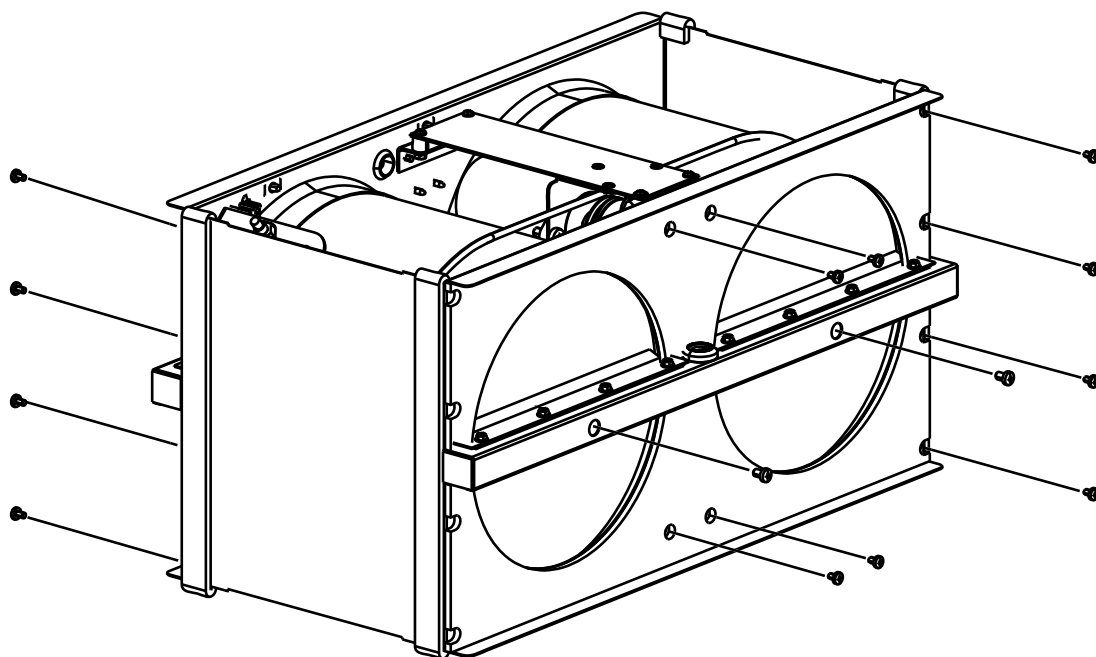

8

Take off heat exchanger side gable (pos 1) and remove faulty rotor motor belt (pos 2).

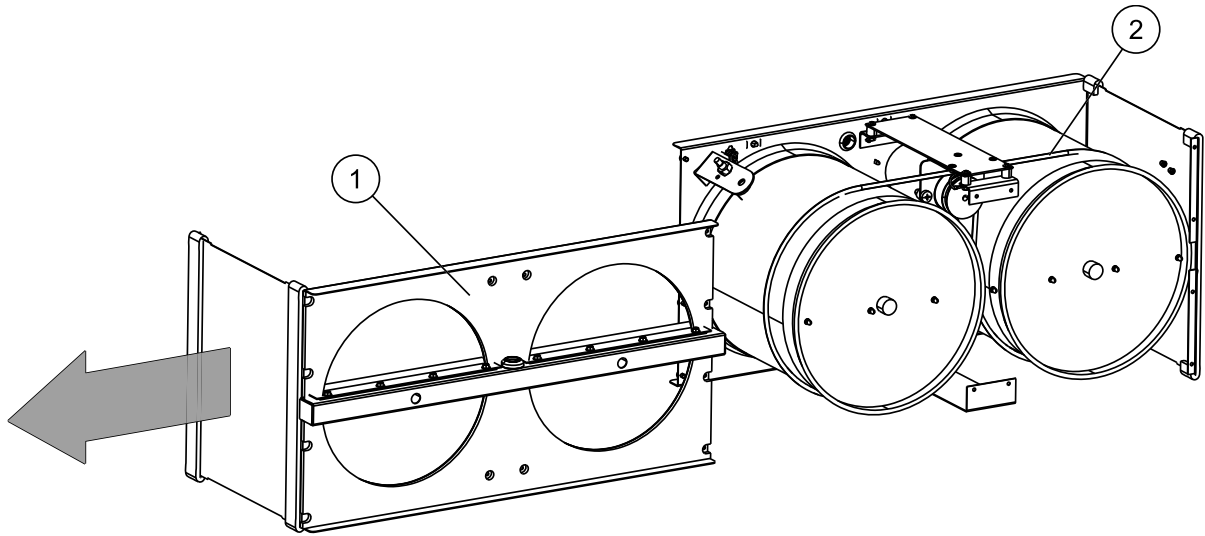

9

Place the new drive belt (pos 1) around both heat exchangers (pos 3) and the belt pulley (pos 2) as shown in the illustrations below (side and top view). Make sure the new drive belt is aligned or else it can slip off.

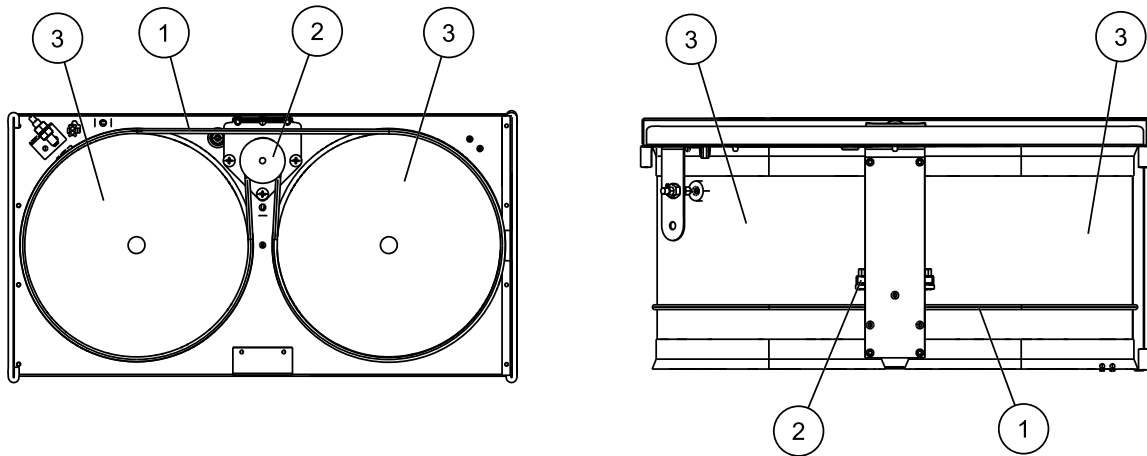



## 10

Remount the side gable (pos 1) and secure it with the screws (pos 2, 8 screws at the front and 4 screws at the back and then 2 screws holding heat exchangers).

It is recommended to tighten motor drive holding screws last (pos 3).

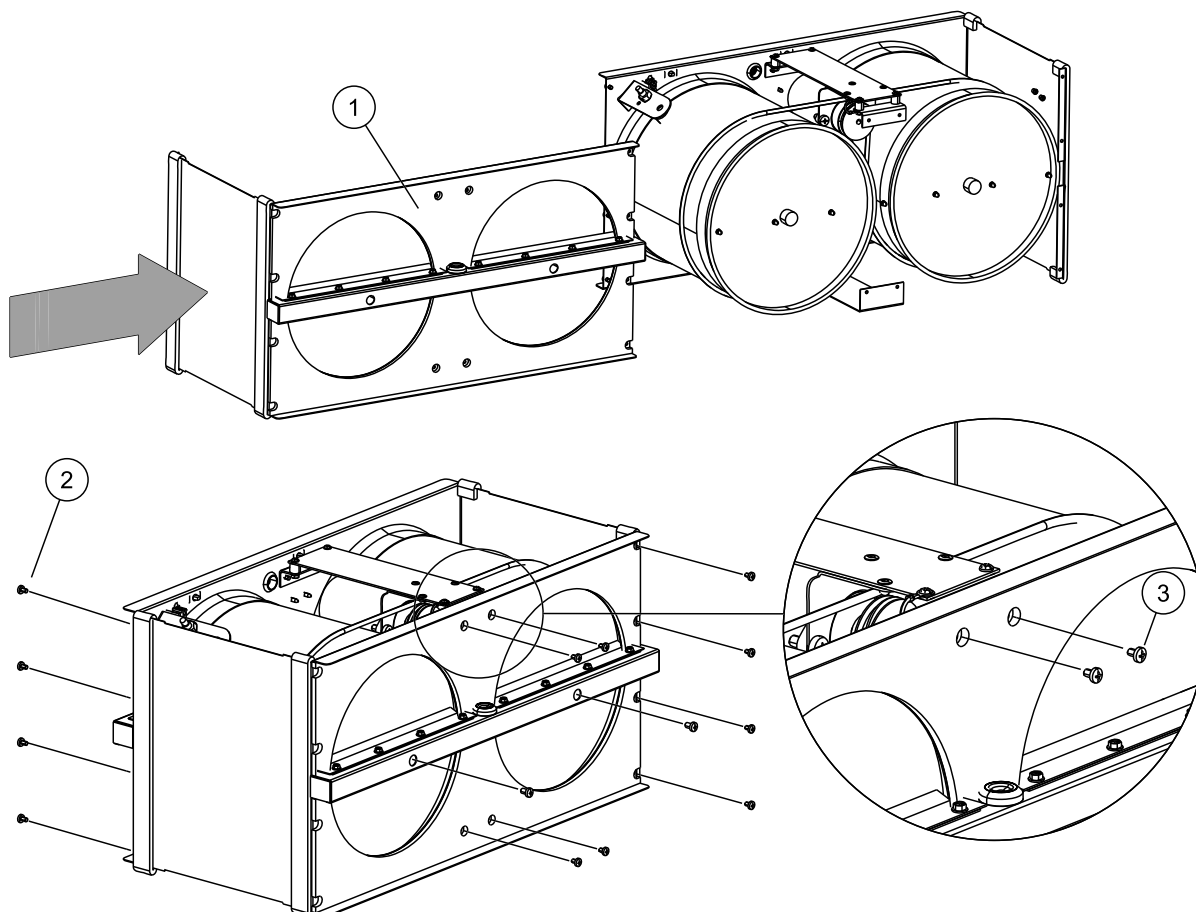

### Important

Rotate the exchanger by hand. Check that the belt pulley rotates and the belt do not slip.

# 11

Remount the heat exchanger package in the way it was taken out.

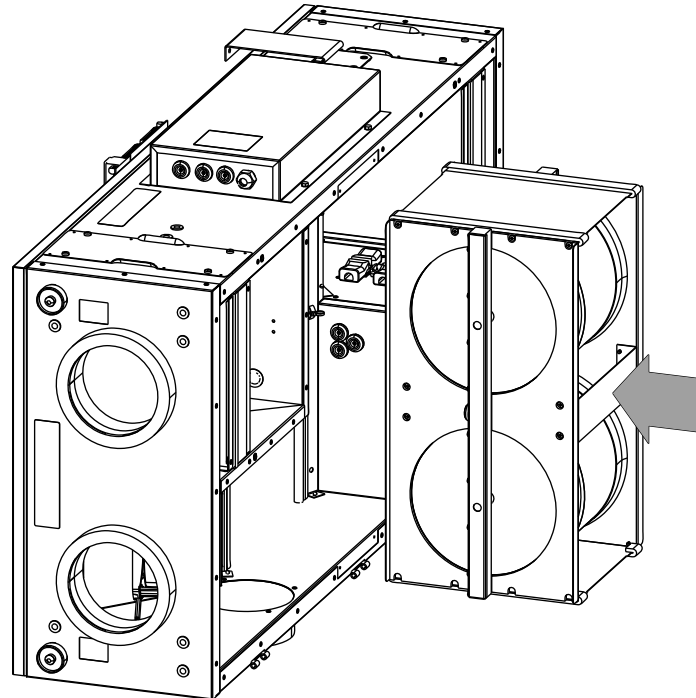

# 12

Secure the heat exchanger with the screws (pos 1) and the brackets (pos 2).

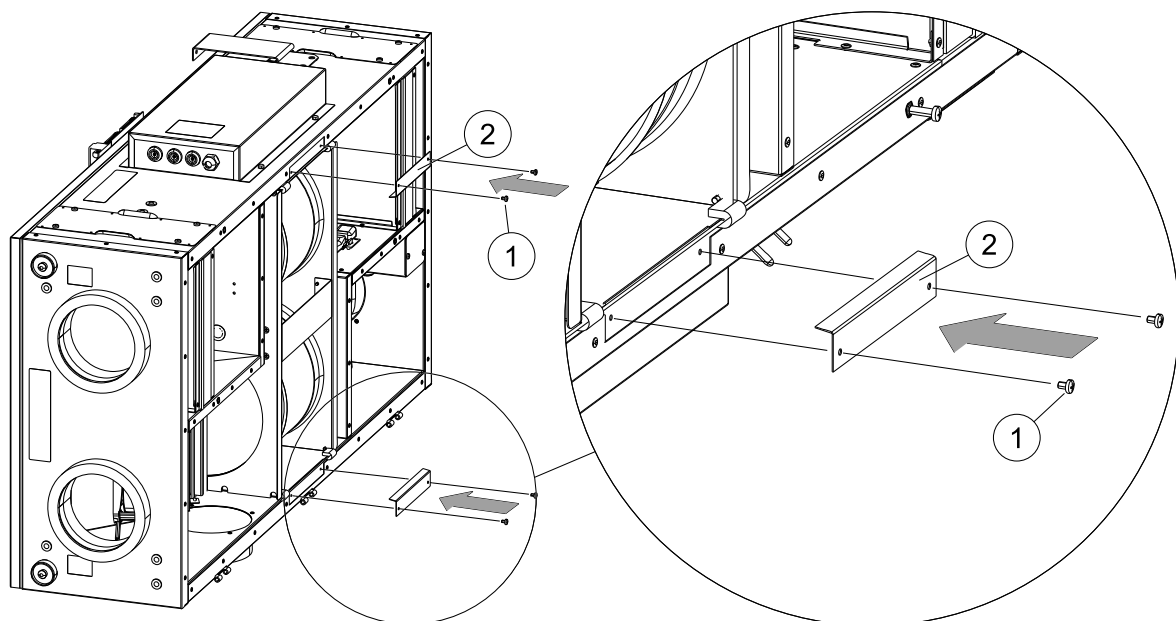

### 13

Reconnect the heat exchanger quick release connections.

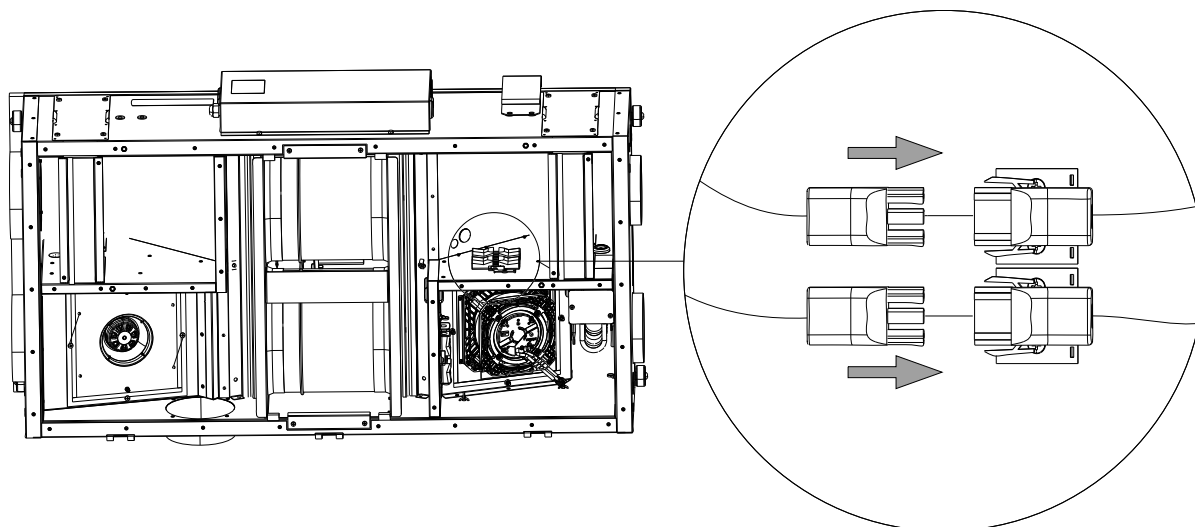

If the filter was removed in order to disconnect quick release connections, assemble all parts in reverse order: reconnect quick release connections (pos 4), mount filter (pos 3), place the bracket (pos 2) and tighten it with screws (pos 1).

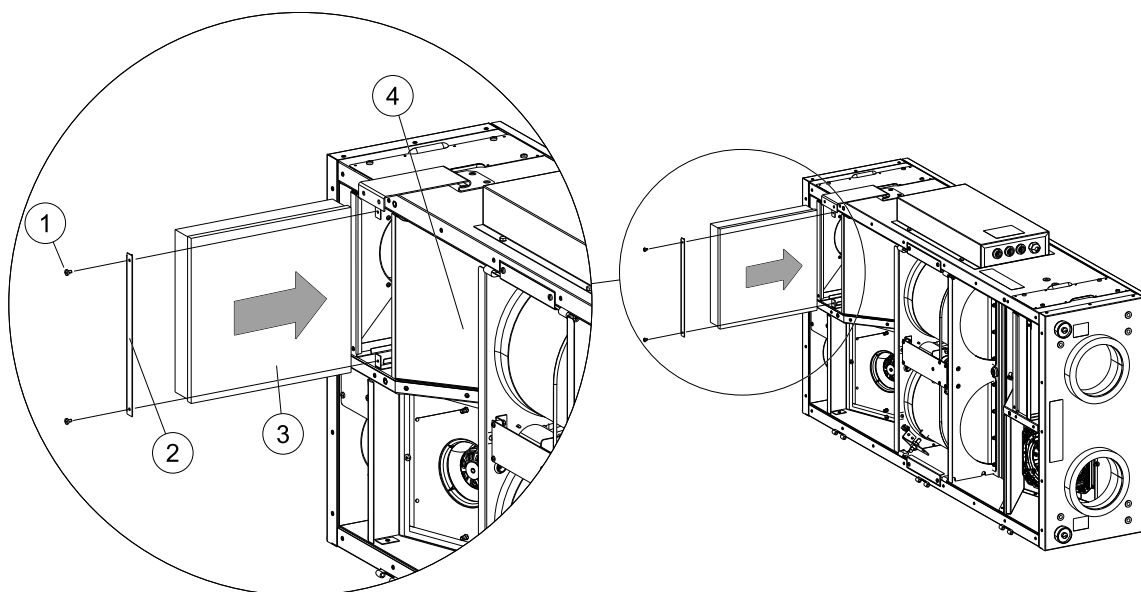

### 14

Close and fasten the side cover and connect the unit to mains supply.

### 15

Check that the alarm has ceased on the Control Display.

#### Note:

If the alarm remains, check the rotor sensor.

Systemair AB reserves the right to make changes and improvements to the contents of this manual without prior notice.



Systemair AB  
Industrivägen 3  
SE-739 30 Skinnkatteberg, Sweden

Phone +46 222 440 00

Fax +46 222 440 99