



RSI EC



- EC-motors, high level of efficiency
- 100% speed controllable
- Integrated motor protection
- Can be installed in any position
- Potentiometer included for ease of commissioning

The RSI EC models have impellers with backward curved blades and are fitted to EC external rotor motors. These fans have a high capacity in relation to their compact design. The fans are delivered with a pre-wired potentiometer (0-10V) which allows you to easily find the desired working point.

The RSI models are thermally and acoustically insulated with 50 mm mineral wool and perforated sheet steel on the inner surface.

Motor protection is integrated in the electronics of the motor. The casing is manufactured from galvanized steel.

Electrical accessories



EC-Vent p. 365



CXE/AV p. 369



S-ET p. 373



MTV/MTP p. 359



REPT/RETP p. 370



REV p. 380

Quick selection

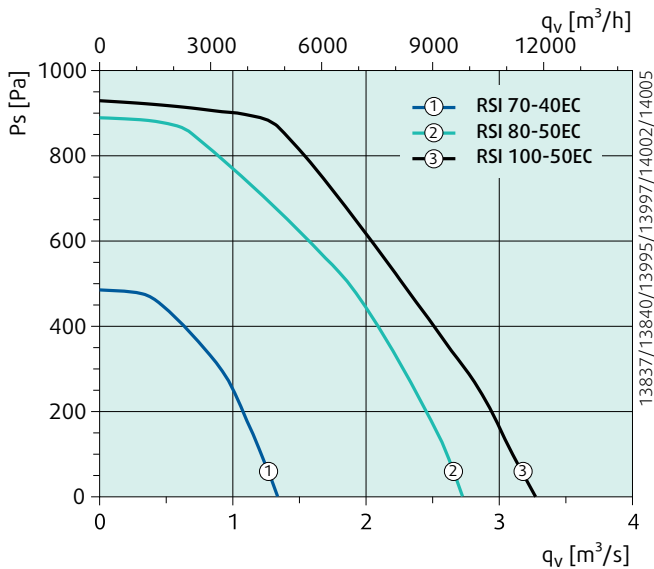

Technical data

Smaller sizes coming soon!

RSI		70-40EC	80-50EC	100-50EC
Art. no.		17827	17828	17829
Voltage/Frequency	V/50 Hz	230 1~	400 3~	400 3~
Power	W	605	2144	2724
Current	A	2.75	3.27	4.15
Max. air flow	m³/s	1.34	2.72	3.27
R.p.m.	min ⁻¹	1403	1509	1400
Max. temp. of transported air	°C	60	60	40
Sound pressure level at 3 m	dB(A)	53	61.4	63
Weight	kg	72	119	154
Insulation class, motor		F	F	F
Enclosure class, motor		IP 54	IP 54	IP 54
Motor protection		Integral	Integral	Integral
Wiring diagram p. 442-461		58	59	59

Dimensions

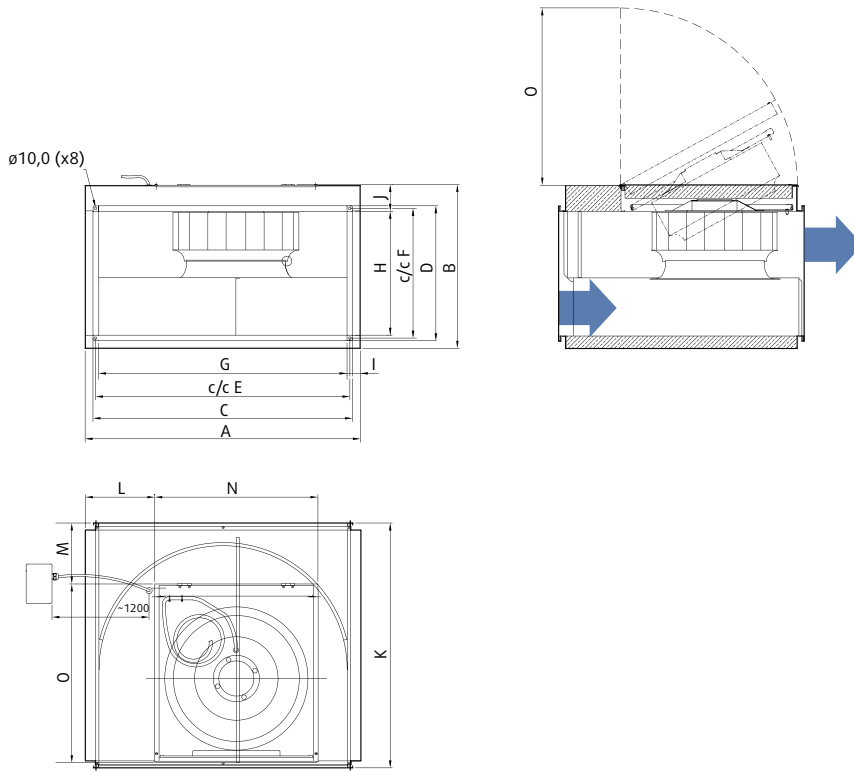

RSI	A	B	C	D	E	F	G	H	I	J	K	L	M	N	O
70-40EC	808	564	741	441	720	420	697	397	55.5	114	787	202	170	532	596
80-50EC	908	683	841	541	820	520	797	497	55.5	133	882	195	144	656	716
100-50EC	1108	683	1041	541	1020	520	998	498	55.5	133	982	302	215	678	746

Ventilation accessories



DS p. 399



VK p. 412



LDR p. 400



FFK p. 401



RB p. 402



VBR p. 406



DXRE p. 405

Performance

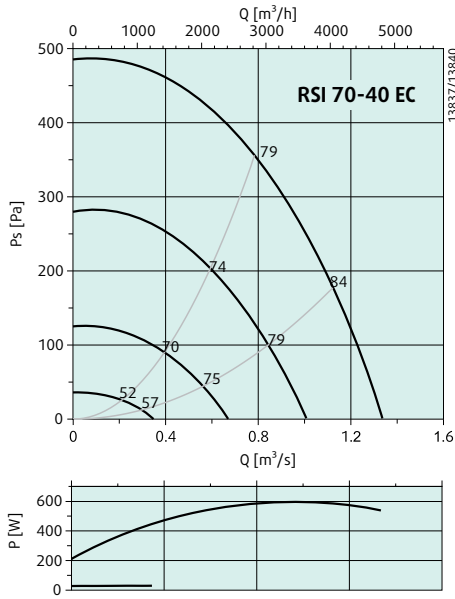

dB(A)	Tot	Frequency bands [Hz]							
		63	125	250	500	1k	2k	4k	8k
L _{WA} Inlet	70	53	65	65	65	59	57	53	47
L _{WA} Outlet	84	61	71	80	78	76	74	65	57
L _{WA} Surrounding	60	36	52	54	55	53	50	46	44

Measurement point: 0.802 m³/s @ 336 Pa

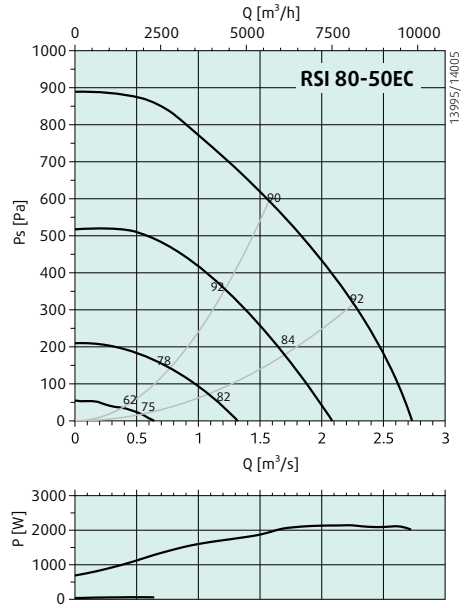

dB(A)	Tot	Frequency bands [Hz]							
		63	125	250	500	1k	2k	4k	8k
L _{WA} Inlet	83	71	78	76	78	72	72	68	61
L _{WA} Outlet	93	72	81	88	87	87	82	76	67
L _{WA} Surrounding	68	52	62	61	62	60	59	54	48

Measurement point: 1.36 m³/s @ 629 Pa

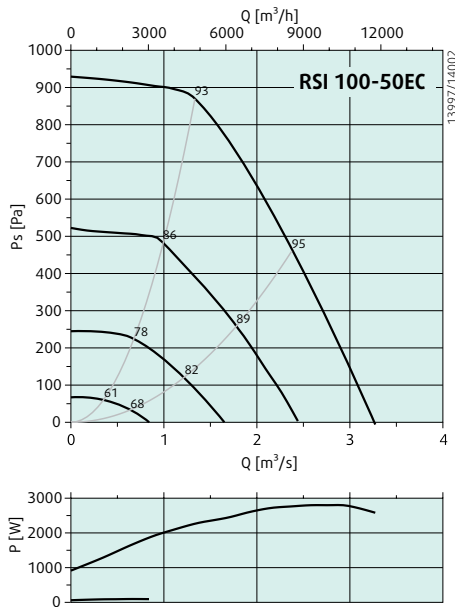

dB(A)	Tot	Frequency bands [Hz]							
		63	125	250	500	1k	2k	4k	8k
L _{WA} Inlet	83	76	80	73	74	69	69	65	59
L _{WA} Outlet	93	78	84	87	86	87	83	77	69
L _{WA} Surrounding	70	57	66	59	60	61	62	57	52

Measurement point: 1.31 m³/s @ 876 Pa