

Square duct fans



KDRD

- Speed-controllable
- Integral thermal contacts
- Can be installed in any position
- Maintenance-free and reliable

KDRD fans have external rotor motors and mixed flow impeller. The KDRD series is notable for its relatively high static pressure and high level of efficiency. The casing is manufactured from galvanised sheet steel.

To protect the motor from overheating, the KDRD fans have integral thermal contacts with leads for connection to a motor protection device.

The fans can be installed in any position and are simple to couple using DS flexible connections.

ELECTRICAL ACCESSORIES



S-ET/STD T
p. 341-342



RTRE p. 320



REU p. 320



REE p. 321



RTRD/RTRDU
p. 321

QUICK SELECTION

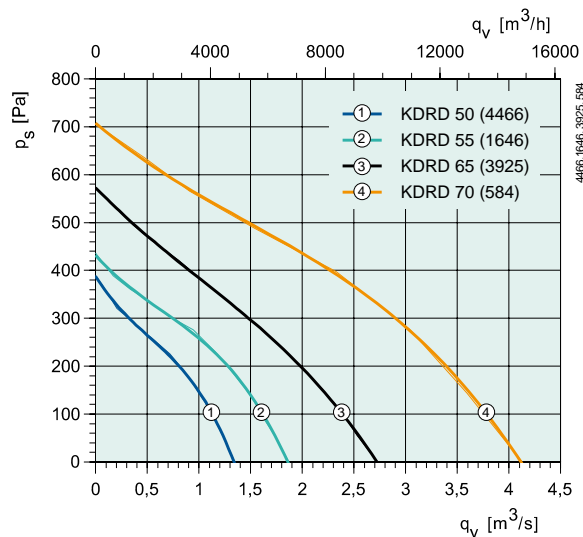

TECHNICAL DATA

				KDRD 50		KDRD 55	
Art no.		1311	1313	1314	1315	1316	1317
Voltage/Frequency	V/50 Hz	230 1~	230 1~	400 3~	230 1~	400 3~	230 1~
Power	W	325	442	462	861	789	1501
Current	A	1.55	1.94	0.962	4.10	1.52	6.61
Max air flow	m³/s	1.00	1.27	1.34	1.94	1.87	3.07
R.p.m.	min-1	1387	1297	1397	1280	1315	1315
Max temp. of transported air	°C	70	70	70	45	49	70
" when speed controlled	°C	70	70	70	45	40	70
Sound pressure level at 3 m	dB(A)	45	52	54	51	55	61
Weight	kg	23.5	31	29	41	38	54
Insulation class, motor		F	F	F	F	F	F
Enclosure class, motor		IP 54	IP 54	IP 54	IP 54	IP 54	IP 54
Capacitor		8	10	-	16	-	30
Motor protection		S-ET 10	S-ET 10	STD T 16	S-ET 10	STD T 16	S-ET 10
Speed control, five-step	Transformer	RTRE 3	RTRE 5	RTRD 2	RTRE 5	RTRD 2	RTRE 7
Speed control, five step high/low	Transformer	REU 3*	REU 5*	RTRDU 2	REU 5*	RTRDU 2	REU 7*
Speed control, stepless	Thyristor	REE 2*	REE 4*	-	-	-	-
Wiring diagram p. 391-400		6	6	8	6	8	6

* + S-ET 10

DIMENSIONS

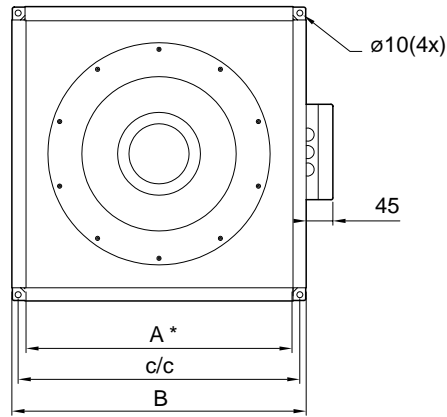
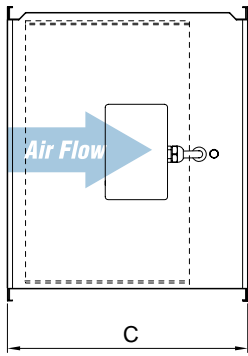

	A	c/c	B	C
KDRE 45	447	470	492	400
KDRE/D 50	502	520	547	450
KDRE/D 55	550	573	595	485
KDRE/D 65	661	680	707	510
KDRE	696	720	740	530

VENTILATION ACCESSORIES

-  DSK p. 370
-  LDK p. 365
-  FFS p. 368
-  RBK p. 368
-  VBK p. 367

Square duct fans

		KDRD 65	KDRD 70			
Art no.		1318	6690			
Voltage/Frequency	V/50 Hz	400 3~	400 3~			
Power	W	1250	2489			
Current	A	2.23	4.67			
Max air flow	m ³ /s	2.72	4.12			
R.p.m.	min ⁻¹	1341	1383			
Max temp. of transported air	°C	70	70			
" when speed controlled	°C	56	69			
Sound pressure level at 3 m	dB(A)	53	62			
Weight	kg	50	62			
Insulation class, motor		F	F			
Enclosure class, motor		IP 54	IP 54			
Motor protection		STDT 16	STDT 16			
Speed control, five-step	Transformer	RTRD 4	RTRD 7			
Speed control, five step high/low	Transformer	RTRDU 4	RTRDU 7			
Speed control, stepless	Thyristor	-	-			
Wiring diagram p. 391-400		8	8			

Square duct fans

PERFORMANCE

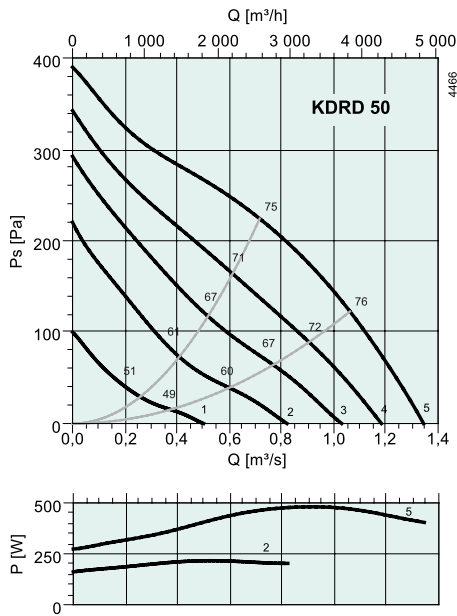

dB(A)	Tot	Frequency bands [Hz]							
		63	125	250	500	1k	2k	4k	8k
L_{wA} Inlet	75	59	65	69	71	68	65	58	49
L_{wA} Outlet	79	57	68	69	71	75	71	63	54
L_{wA} Surrounding	61	30	51	57	53	56	52	44	36
With LDK 50									
L_{wA} Inlet	66	59	58	61	58	56	56	50	42
L_{wA} Outlet	69	57	61	61	58	63	62	55	47
Measurement point: 0,717 m^3/s ; 224 Pa									

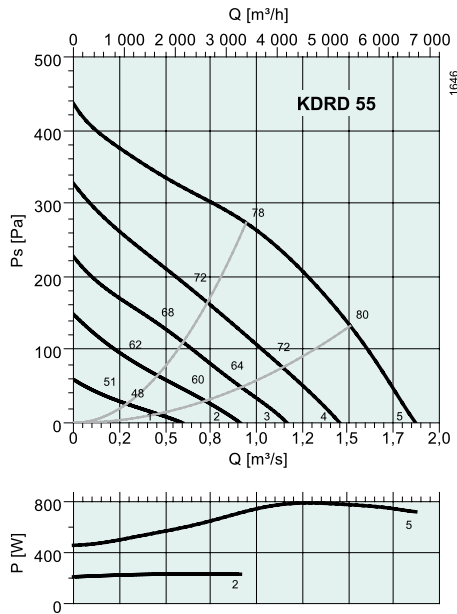

dB(A)	Tot	Frequency bands [Hz]							
		63	125	250	500	1k	2k	4k	8k
L _{WA} Inlet	76	56	61	69	71	70	68	61	54
L _{WA} Outlet	80	59	65	69	74	77	73	65	57
L _{WA} Surrounding	62	57	48	59	51	50	47	44	44
With LDK 55									
L _{WA} Inlet	66	56	52	60	58	58	58	52	46
L _{WA} Outlet	70	59	56	60	61	65	63	56	49

Measurement point: 0,944 m³/s; 273 Pa

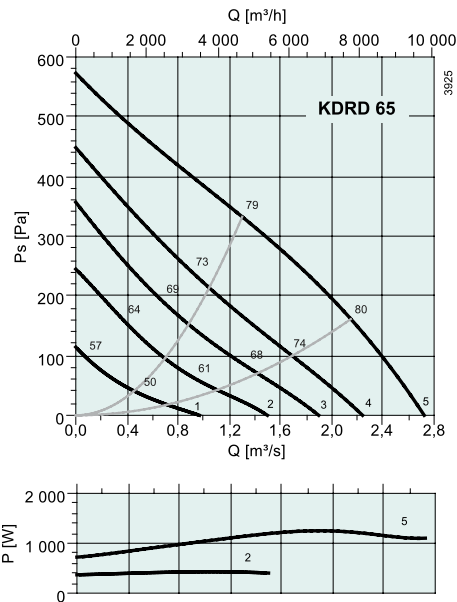

dB(A)	Tot	Frequency bands [Hz]							
		63	125	250	500	1k	2k	4k	8k
L _{WA} Inlet	79	62	70	72	72	71	64	57	
L _{WA} Outlet	84	62	68	70	78	81	77	69	61
L _{WA} Surrounding	60	40	47	58	50	50	49	37	27
With LDK 65									
L _{WA} Inlet	70	62	64	65	58	59	62	56	50
L _{WA} Outlet	73	62	62	63	64	68	68	61	54

Measurement point: 1,3 m³/s; 332 Pa

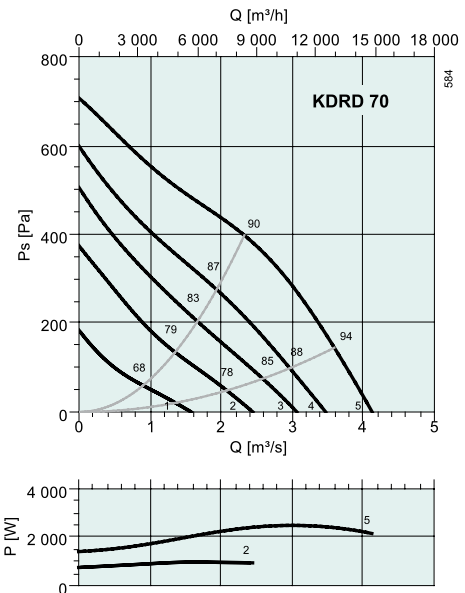

dB(A)	Tot	Frequency bands [Hz]							
		63	125	250	500	1k	2k	4k	8k
L _{WA} Inlet	84	75	74	77	77	78	76	69	65
L _{WA} Outlet	89	74	76	79	82	85	80	73	67
L _{WA} Surrounding	69	44	54	63	62	64	60	54	49
With LDK 70									
L _{WA} Inlet	77	75	69	70	58	54	53	54	55
L _{WA} Outlet	78	74	71	72	63	61	57	58	57

Measurement point: 2,33 m³/s; 398 Pa