

Centrifugal fans single inlet



KBR/KBT EC

- EC-motors, high level of efficiency
- 100% speed controllable
- Integrated motor protection
- Low noise level
- Max. temp. of continuously transported air 120°C

EC technology is intelligent technology; using integral electronic control which eliminates the slip losses in the motor and ensures that the motor always runs at optimal load and guarantees that the proportion of energy utilized effectively is many times higher and the energy usage considerably lower compared with AC motors. EC fans are notable for their economical use of energy and excellent ease of control. They can be varied in speed to match the airflow demand, and operate at high efficiency levels. For the same air volume, they consume distinctly less energy than AC fan drives. Another special feature of EC fans is their energy-saving potential not only at full load, but especially at part-load. When operating at partload, the energy used is much lower than with an asynchronous motor of equivalent output. Reduced energy usage guarantees a drop in operating costs. The power electronics are integrated in the motor housing. All models have one potential-free terminal for error message. All motors are suitable to be used for 50/60Hz. The input voltage for single phase units can vary between 200 and 277V. Speed control by a 0-10V signal. Every motor has an output voltage of 10V for an external potentiometer or sensor. The KBR-EC fans have impellers manufactured from aluminium with backward-curved blades. The casing is manufactured from double-skinned galvanized sheet steel and is insulated with 50 mm mineral wool. The KBR-EC fans have a swing-out door for easy inspection and service. The direction of the door opening can easily be changed from left to right at site. The fan is isolated from the casing via connectors and anti-vibration dampers are incorporated into the base frame.



ELECTRICAL ACCESSORIES

MTP 10
p. 341

MTV 1 p. 341



REV p. 340

EC-Vent
p. 329-330

TECHNICAL DATA

KBR-EC										
KBT-EC									200	250
Art. no									33231	33259
Voltage/Frequency	V/50/60 Hz								230 1~	400 3~
Fan power consumption (P1)	W								535	1252
Current	A								2.43	2.01
Max air flow	m ³ /s								0.554	0.925
R.p.m.	min ⁻¹								1498	1370
Max temp. of transported air	°C								70	120
" when speed controlled	°C								70	120
Sound pressure level at 4/10 m	dB(A)								36/28	37/29
Weight	kg								35.6	52.5
Insulation class, motor									F	F
Enclosure class, motor									IP 55	IP 55
Speed control, stepless									MTP 10	MTP 10
Wiring diagram p. 391-400									48	47

DIMENSIONS

VENTILATION ACCESSORIES

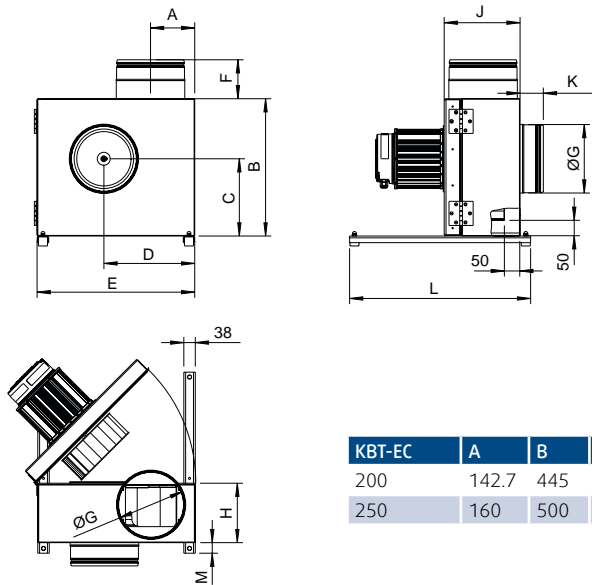

KBT-EC	A	B	C	D	E	F	øG	H	J	K	L	M
200	142.7	445	249	292	510	130	200	174	232	78	450	35
250	160	500	285	333	576	130	250	213	272	78	600	35

QUICK SELECTION

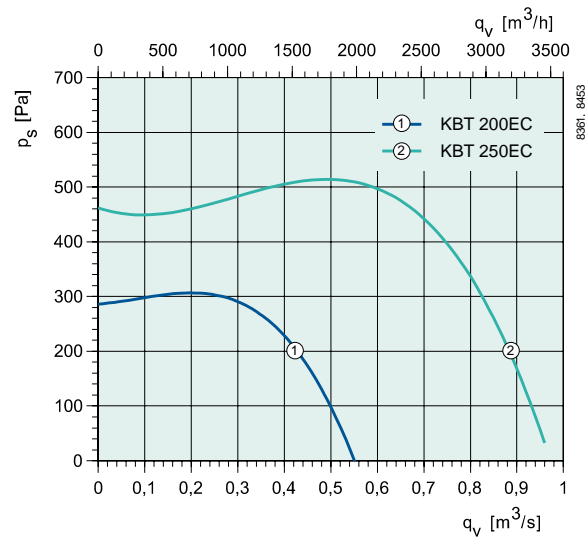

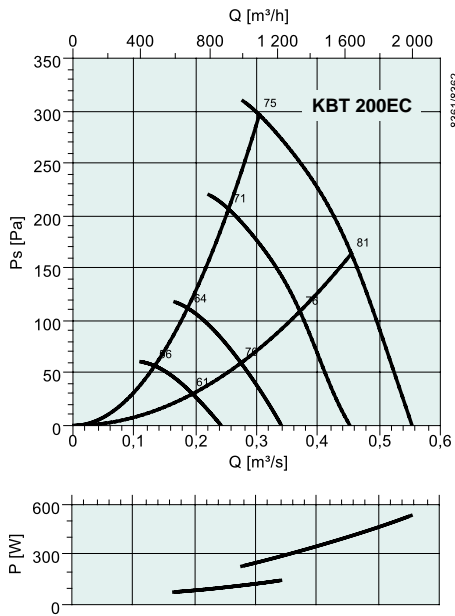

dB(A)	Tot	Frequency bands [Hz]							
		63	125	250	500	1k	2k	4k	8k
L _{wA} Inlet	75	60	59	72	66	68	64	62	56
L _{wA} Outlet	77	63	69	74	69	68	64	62	56
L _{wA} Surrounding	59	26	23	53	50	49	54	52	42

Measurement point: 0,304 m³/s; 296 Pa

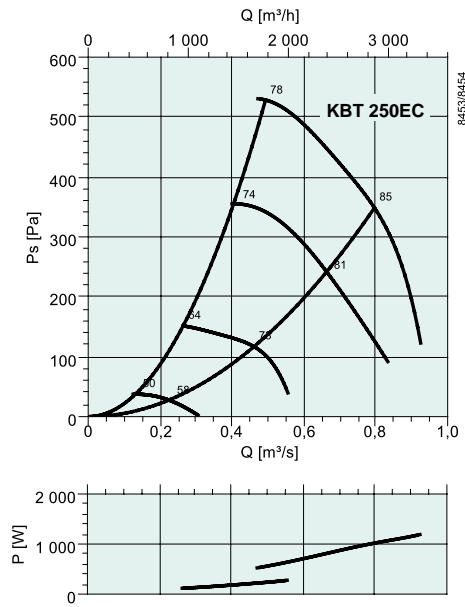

dB(A)	Tot	Frequency bands [Hz]							
		63	125	250	500	1k	2k	4k	8k
L _{wA} Inlet	78	51	68	69	69	73	70	69	64
L _{wA} Outlet	80	58	68	73	73	75	71	70	63
L _{wA} Surrounding	60	12	45	51	50	54	53	55	50

Measurement point: 0,493 m³/s; 528 Pa