

## Photo

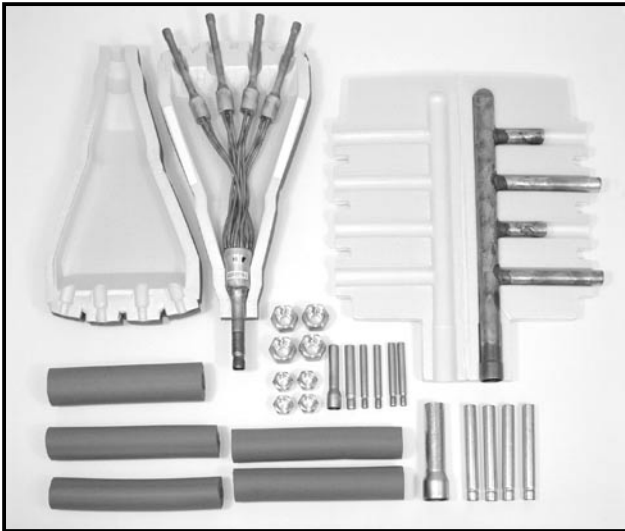

## Descriptions

4-branch pipe for Multi-System Quadruple use.(25:25:25:25)

## Applicable Models

- PU-P200/250
  - PUH-P200/250
  - PUHZ-RP200/250
- for 25:25:25:25 Quadruple use

## Specifications

Main body	Distribution ratio	Outdoor unit capacity is divided into four (25:25:25:25)
	Number of distribution pipes	1 each for liquid pipe and gas pipe
	Pipe material	Phosphate deoxidized copper C1220T-OL (JIS H3300)
Accessory	Pipe cover	Polyethylene foam molding (for liquid pipe) EPT sponge rubber type (for gas pipe)
	Joint	11 joints (5 types)
	Band	7 bands

## Dimensions

Unit : mm

### LIQUID PIPE

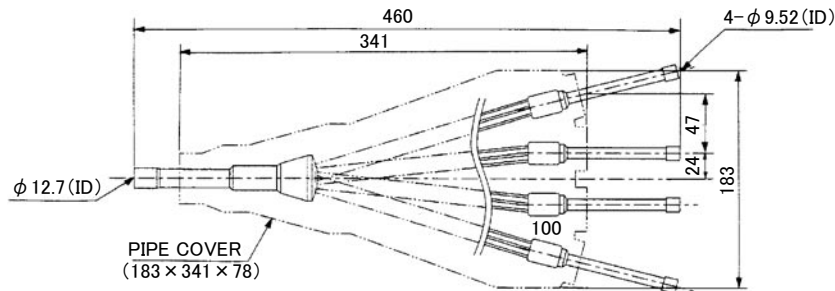

### GAS PIPE

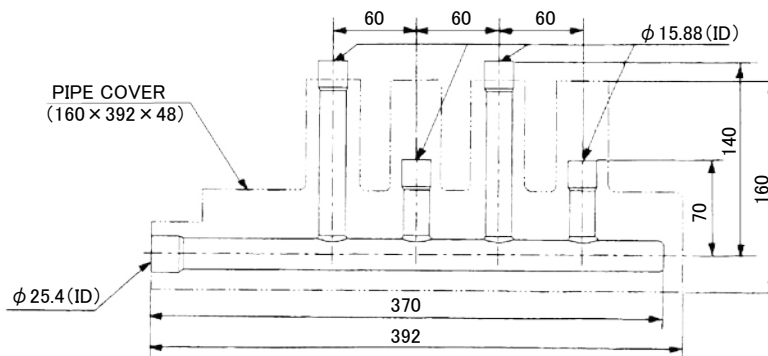

### JOINT(Accessory)

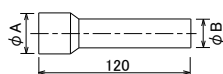

ΦA(ID)	ΦB(OD)	Amount
28.6	25.4	1
15.88	12.7	1

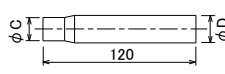

ΦC(ID)	ΦD(OD)	Amount
12.7	15.88	4
6.35	9.52	4
9.52	12.7	1

# How to Use / How to Install

## Package Air-conditioner Optional Parts Instruction Sheet for Simultaneous Quadruple Distributing Pipe exclusively used with Free Compo Multi-Units

Model MSDF-1111R-E [Indoor unit(quaduple)With same-capacity 25:25:25:25]..... Outdoor unit PUH-P8~10, 200~250MYA type (R407C fixed speed)  
 Outdoor unit PUHZ-RP8~10, 200~250HA type (R410A power inverter)

• Make sure that you have all the following parts in packing box before beginning installation:

① Installation manual This sheet 1 sheet	② Gas pipe 1pc	③ Liquid pipe 1pc	④ Pipe cover (gas pipe) 1pc	⑤ Pipe covers (liquid pipe) 2pcs	⑥⑦ Pipe cover ⑥ OD Φ42×180L-1pc ⑦ Φ38×200L-4pcs	⑧ Band 7pcs	⑨ Joint <ul style="list-style-type: none"> <li>Φ9.52→Φ6.35...4pcs</li> <li>Φ12.7→Φ9.52...1pcs</li> <li>Φ12.7→Φ15.88...1pcs</li> <li>Φ15.88→Φ12.7...4pcs</li> <li>Φ25.4→Φ28.6...1pcs</li> </ul>	⑩ Flare nut <ul style="list-style-type: none"> <li>1/4F...4pcs</li> <li>1/2F...4pcs</li> </ul> For R410A indoor unit.
---	-------------------	----------------------	--------------------------------	-------------------------------------	---	----------------	---	--

● the gas pipe ② and liquid pipe ③ are specified as shown below.

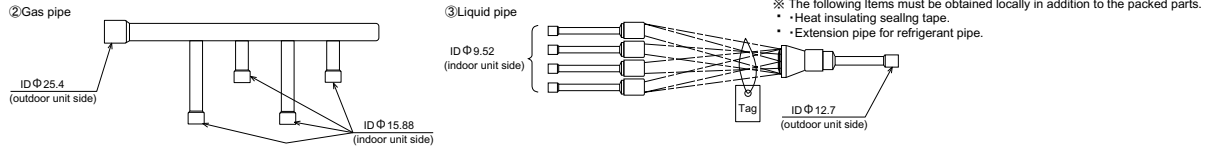

• Pipe size and refrigerant pipe limits.

Outdoor unit capacity	Pipe size (mm)				Actual pipe length (m)		Height Difference (m)		Note 1 Number of bends
	Gas pipe side		Liquid pipe side		Indoor-Outdoor	Indoor-Indoor	Indoor-Outdoor	Indoor-Indoor	
200 (8Hp)	Φ25.4 (1)	Φ15.88 (5/8)	Φ12.7 (1/2)	Φ9.52 (3/8)	A+B=	B-C =	H =	h =	15 or less
250 (10Hp)	Φ28.6 (1-1/8)				A+C =	B-D =	40m or less	1m or less	
					A+D =	B-E =			
					A+E =	C-D =			
					50m or less	D-E =			
						8m or less			

Outdoor unit capacity	Pipe size (mm)				Actual pipe length (m)		Height Difference (m)		Note 1 Number of bends
	Gas pipe side		Liquid pipe side		Indoor-Outdoor	Indoor-Indoor	Indoor-Outdoor	Indoor-Indoor	
200 (8Hp)	Φ25.4 (1)	Φ12.7 (1/2)	Φ9.52 (3/8)	Φ6.35 (1/4)	A+B =	B-C =	H =	h =	15 or less
250 (10Hp)	Φ28.6 (1-1/8)	Φ15.88 (5/8)	Φ12.7 (1/2)	Φ9.52 (3/8)	A+C =	B-D =	40m or less	1m or less	
					A+D =	B-E =			
					A+E =	C-D =			
					80m or less	D-E =			
						8m or less			

Note 1: The number of bends in the refrigerant pipes is respectively 8 or less in the range of (A+B)(A+C)(A+D)(A+E).

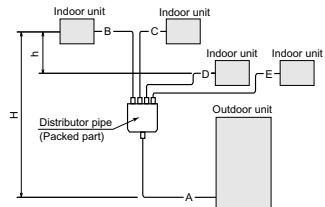

• Pipe connections

- Perform work, taking care with the following:
  - Be sure to check the combination pattern of indoor and outdoor units, joints to be used (Table 2), pipe size and joint used ⑨.
  - Be sure to observe the limits to refrigerant pipe length and number of bends (Table 1).
  - Insert the refrigerant pipe (procured at local site) and joint ⑨ into the expanded pipe portions of distributing pipe (this product) until they stop, and then connect them using anti-oxidation soldering.
  - There is no restriction on the orientation of distributing pipe (this product) during installation.
  - Take care that no foreign object, such as dust, enters during pipe connecting work.
  - Remove the tag of liquid pipe ③ after checking it.
- Pipe connections
  - The provided joints ⑨ will be necessary depending on the capability of model used: See (Table 2), and connect the refrigerant piping.
  - Do not bend or widen the distributing pipe (liquid pipe).

Combination pattern of indoor and outdoor units and joints to be used:

Outdoor unit	Indoor unit	Joint to be used
200 (8Hp)	50+50+50+50 (2+2+2+2)	No Joint is necessary
250 (10Hp)	60+60+60+60 (2.5+2.5+2.5+2.5)	Outer Φ25.4—inner Φ28.6 (outdoor gas pipe side) × 1

Outdoor unit	Indoor unit	Joint to be used
200 (8Hp)	50+50+50+50 (2+2+2+2)	Outer Φ15.88—inner Φ12.7 (indoor gas pipe side) × 4, Outer Φ9.52—inner Φ6.35 (indoor liquid pipe side) × 4, Outer Φ12.7—inner Φ9.52 (outdoor gas pipe side) × 1.
250 (10Hp)	60+60+60+60 (2.5+2.5+2.5+2.5)	Outer Φ25.4—inner Φ28.6 (outdoor gas pipe side) × 1

• Heat insulation work

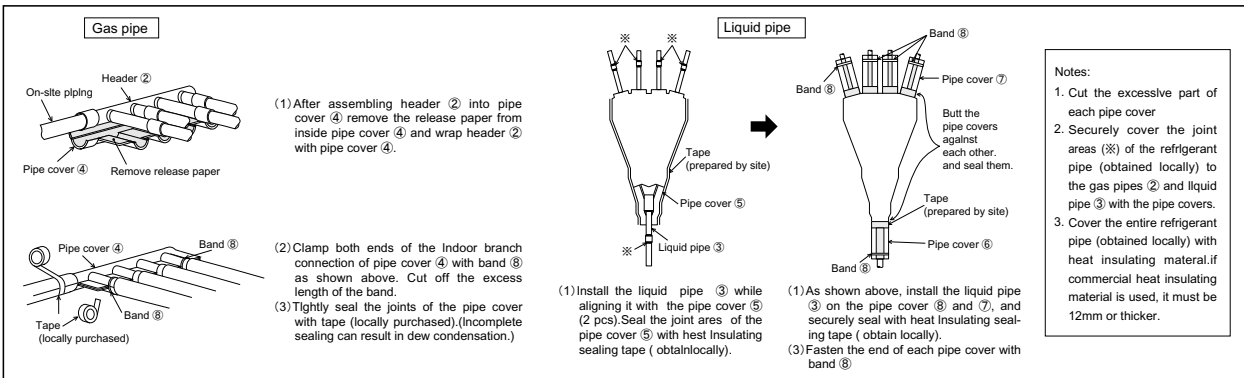

Please install contents other than this description on the main part of a product with an attached installation description, and use them as it.