

Safety precautions

- Before installation, make sure to read all the "Safety precautions that must be followed" and perform it accurately.
- The precautions herein provide very important points regarding safety. Make sure you follow them.
- Please report to your supply authority or obtain their consent before connecting the equipment to the power supply system.
- Symbols used in this manual are categorized as follows according to the degree of risk when used improperly:

	Warning	Describes warnings that must be observed to prevent serious consequences, such as serious injury or death of the user.
	Caution	Describes precautions that must be observed to prevent damage to the unit.

- After installation, describe the user "Safety Precautions", how to use, and how to care for and clean the unit following the operation manual, and test run the unit to check whether there are any problems. In addition, direct the user to keep this installation manual together with the operation manual, and, should the users change, to give the manuals to the new user.
- ⊕: Indicates a part which must be grounded.

Warning

<p>Ask the dealer or an authorized technician to install the unit.</p> <ul style="list-style-type: none"> • If the unit is installed improperly by the user, water leakage, electric shock or fire may result. 	<p>Turn off the main power before the installation work.</p> <ul style="list-style-type: none"> • Otherwise, injury or electric shock may result.
<p>Installation must be properly done following this installation manual.</p> <ul style="list-style-type: none"> • If the unit is installed improperly, water leakage, electric shock or fire may result. 	<p>Carefully read the labels affixed to the main unit.</p> <ul style="list-style-type: none"> • If the unit is installed improperly, water leakage, electric shock or fire may result.

Caution

<p>Make sure to install a short circuit breaker to the power.</p> <ul style="list-style-type: none"> • If a short circuit breaker is not installed, electric shock may result. 	<p>Unit must be grounded.</p> <ul style="list-style-type: none"> • Do not connect the ground wires with ground wires for gas pipes, water pipes, conductor rods, or telephones. If the unit is not properly grounded, electric shock may result.
<p>Use proper electrical cables to meet the standard for current capacity.</p> <ul style="list-style-type: none"> • If improper electrical cables are used, short circuit, heat, or fire may result. 	<p>Use fuses with appropriate capacity such as short circuit breaker, hand switch (switch + type B fuse), and circuit breakers for wiring devices.</p> <ul style="list-style-type: none"> • If fuses, wires, and copper wires with larger capacities are used, damage or fire may result.
<p>Electrical wiring must be done without tension.</p> <ul style="list-style-type: none"> • If there is tension on the cables, wire disconnection, electric shock, or fire may result. 	

1. Overview

This kit is used when the power supply of the indoor unit and the outdoor unit is separated. (For PUHZ application only)
Refer to the installation manual of the indoor unit as well.

1:1 System

- The indoor power supply.

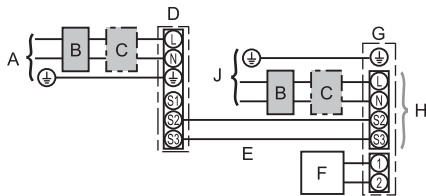

- A Outdoor unit power supply
- B Earth leakage breaker
- C Wiring circuit breaker or isolating switch
- D Outdoor unit
- E Indoor unit/outdoor unit connecting cables
- F Remote controller
- G Indoor unit
- H This terminal kit
- J Indoor unit power supply

* Affix label B that is included with the manuals of indoor unit near each wiring diagram for the indoor and outdoor units.

Simultaneous twin/triple/quadruple system

- The indoor power supply.

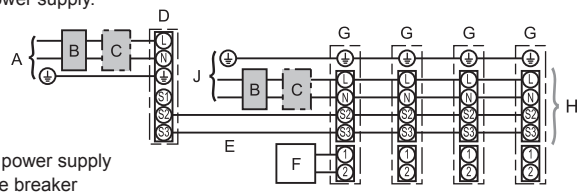

- A Outdoor unit power supply
- B Earth leakage breaker
- C Wiring circuit breaker or isolating switch
- D Outdoor unit
- E Indoor unit/outdoor unit connecting cables
- F Remote controller
- G Indoor unit
- H This terminal kit
- J Indoor unit power supply

* Affix label B that is included with the manuals of indoor unit near each wiring diagram for the indoor and outdoor units.

Note:
Some units cannot be used in a simultaneous twin/triple/quadruple system.
Refer to the outdoor unit installation manual for details.

2. Provided parts

Confirm the following parts are included.

Part	① Terminal block with lead wires	② screw
Qty	1	1
Shape		

3. Installation procedure

Note: Please refer to the electrical work section in the indoor unit's installation manual for how to remove the electrical box cover.

- (1) Remove the electrical box cover.
- (2) Remove the 1 screw and disconnect the connector CN01 (black) and CN3C (blue), and the tab terminal; then remove the terminal block.
- (3) Secure the terminal block ① to the terminal block attachment position using the 1 screw ② in the direction as shown in the figure, then connect the connector CN01 (black) and CN3C (blue), and the tab terminal.

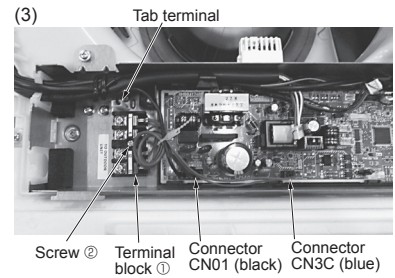
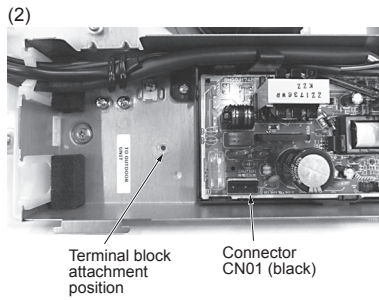
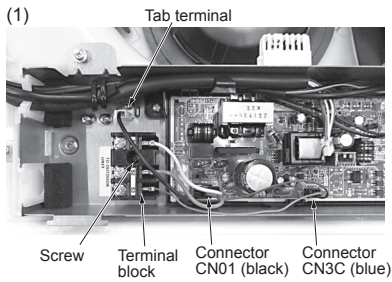

<Attachment method details>

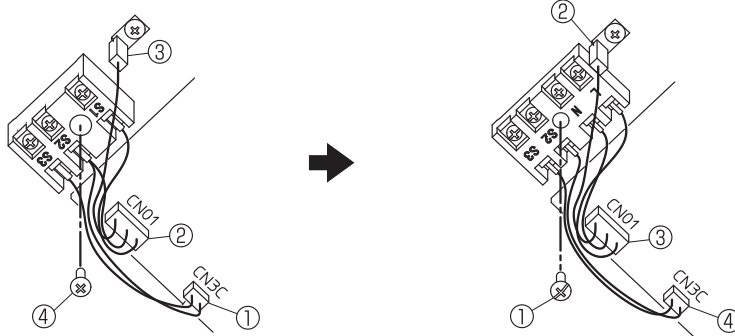

- ① Disconnect connector CN3C (blue) from the indoor controller board.
- ② Disconnect connector CN01 (black) from the indoor controller board.
- ③ Disconnect the tab terminal.
- ④ Remove the screw from the terminal block.

- Install the optional Power supply terminal kit.
- ① Secure the terminal block with the screw.
 - ② Insert the tab terminal.
 - ③ Connect connector CN01 (black) to the indoor controller board.
 - ④ Connect connector CN3C (blue) to the indoor controller board.

4. Electric wiring

Be sure to do the electric wiring according to the indoor unit installation manual.

5. Affix the labels enclosed with the manual of indoor unit near the electric wiring diagrams of both indoor and outdoor units.

Three types of labels (labels A-C) are provided: Affix the label B.
(Separate indoor unit/outdoor unit power supplies... Label B)

6. DIP switch settings of the outdoor unit control board

It is necessary to change the settings of DIP switch on the outdoor unit control board.

Outdoor unit DIP switch settings (when using separate indoor unit/ outdoor unit power supplies only) SW8-3:ON	ON	<input type="checkbox"/>	<input type="checkbox"/>	<input checked="" type="checkbox"/>
	OFF	<input checked="" type="checkbox"/>	<input checked="" type="checkbox"/>	<input type="checkbox"/>

<SW8>

7. Test run

Perform a test run according to the installation manuals of the indoor and outdoor units.