

Pool exchanger

570615

INSTALLATION INSTRUCTIONS



In the pack:

Pool Exchanger 570615,
compatible with:

- **Pool kit 073958**
for PAC alféa S

This exchanger
must be installed and
put into service by
a professional.

*Please read this document
carefully before you begin the
installation work. When the in-
stallation has been completed,
be sure to file these instructions
away securely.*

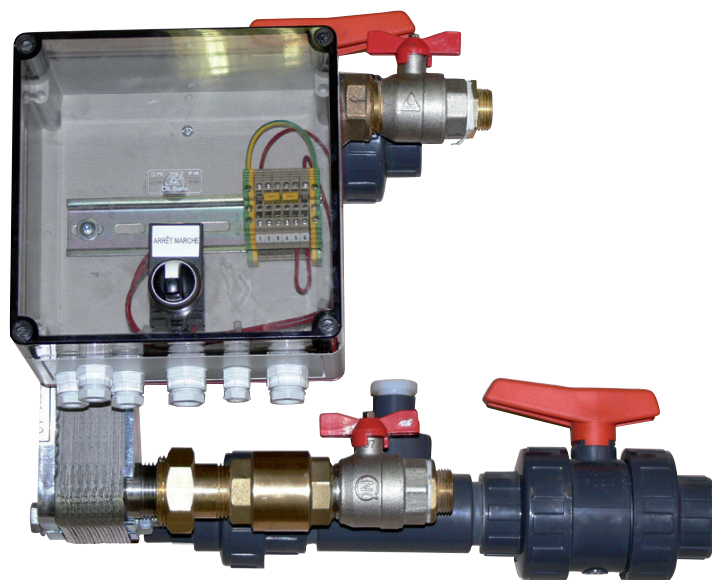

Pool exchanger

Code 570615

*This document is intended
for qualified personnel.*

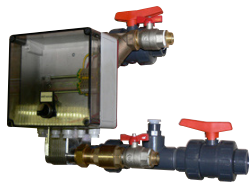

◆ Description

- 1 Exchanger
- 2 Pack inlet (brass valve)
- 3 Return toward Pack (brass valve)
- 4 Outlet to pool (PVC pipe)
- 5 Return from pool (PVC pipe)
- 6 Housing for the return probe
- 7 On/off switch
- 8 Filter

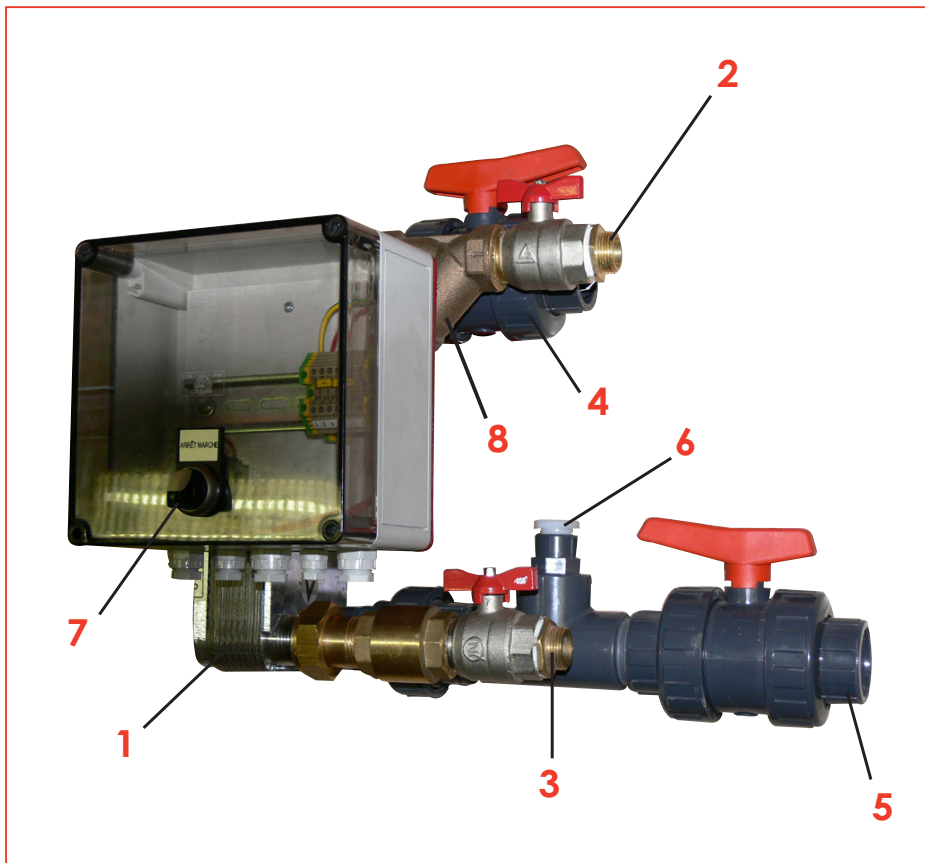

◆ Return probe

Place the return probe in the housing provided for this purpose (see caption 6 above).

◆ General characteristics

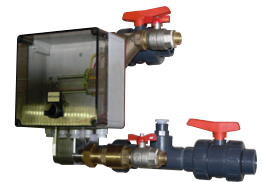

For an exchanger power of 17 kW

- Hydraulic connections: 1 " (26x34 mm)
- Maximum working pressure: 3 bar

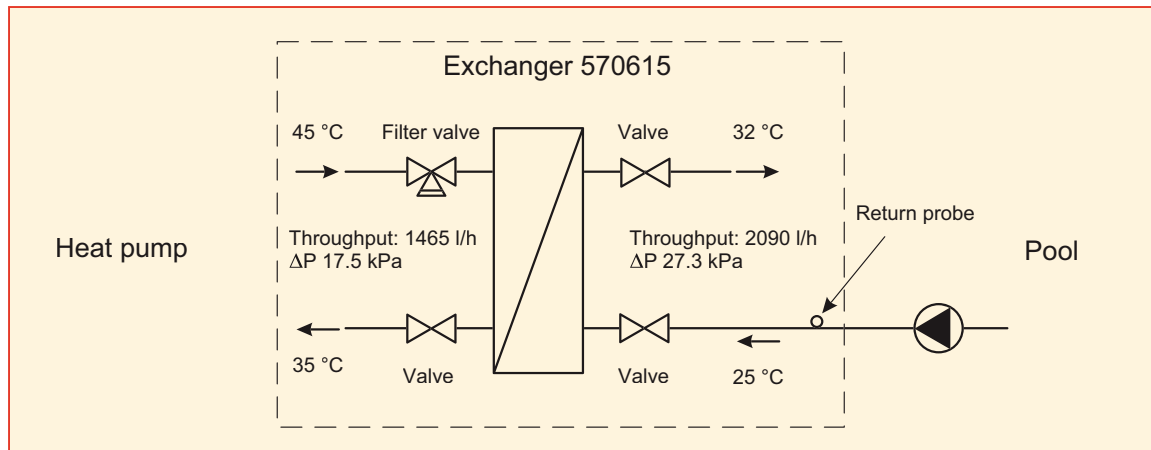

Schematic hydraulic diagram and characteristics

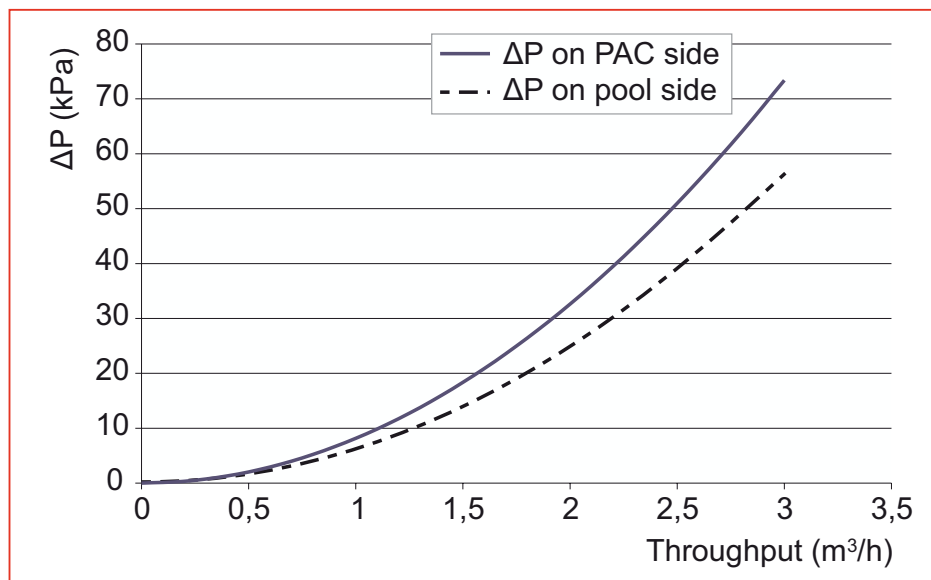

Pressure drop in the hydraulic circuit

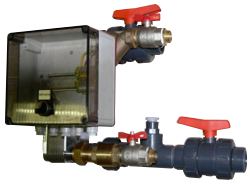

◆ Attachment of the exchanger support

Attach the exchanger firmly to a substantial wall (not to a light partition), making sure that it is correctly levelled.

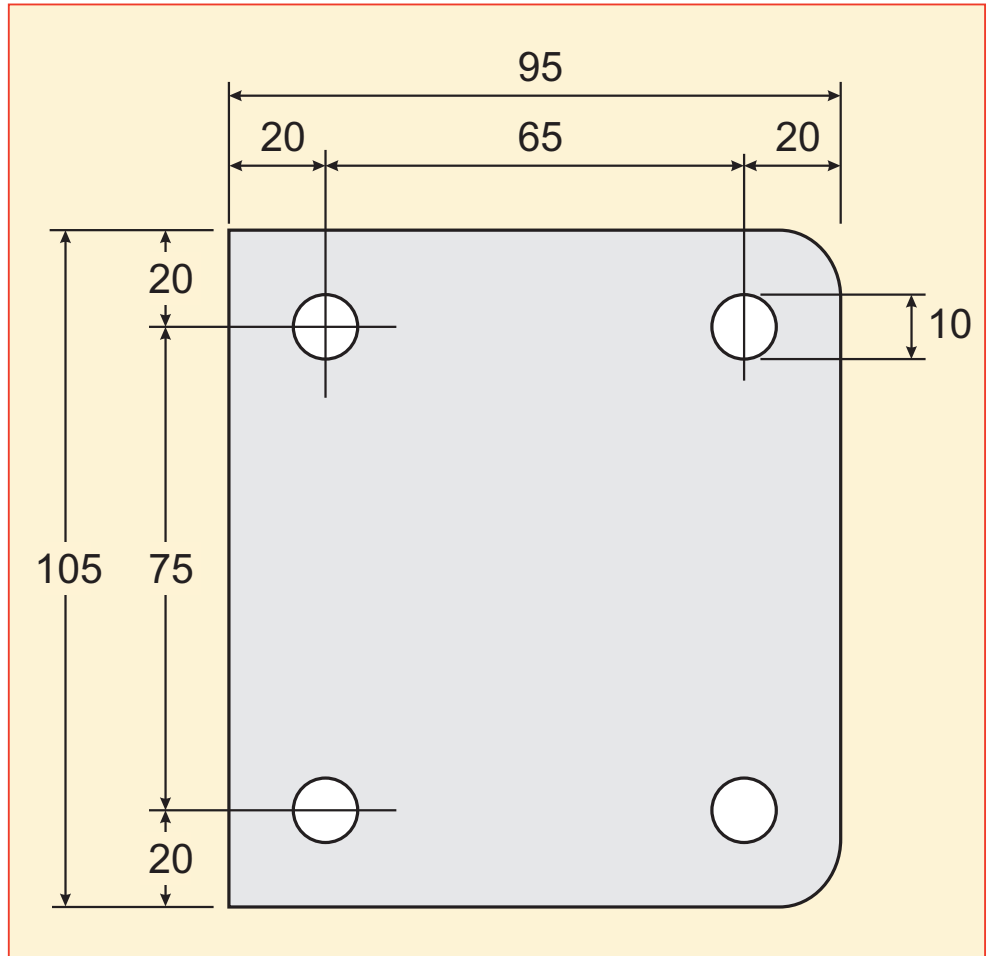

Attachment of the support (dimensions in mm)

◆ Basic electrical diagram

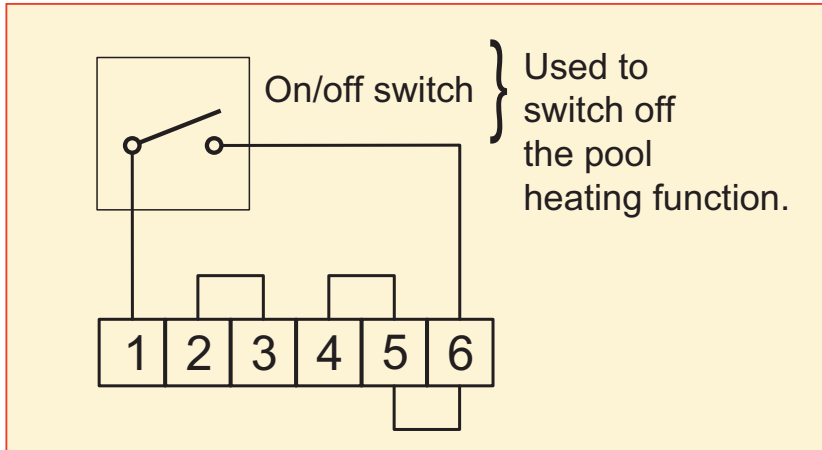
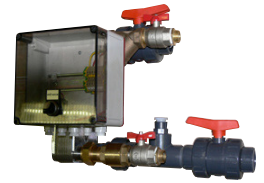

Electric wiring

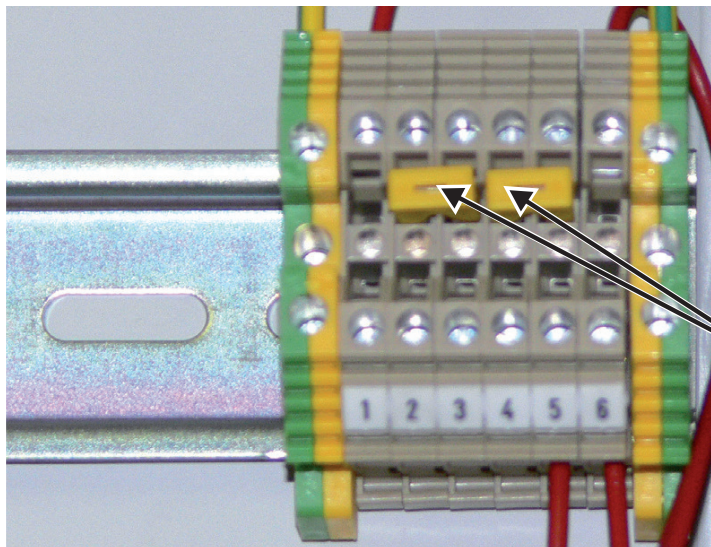

Jumper shunts:
(2-3) and (4-5)

Jumper shunts

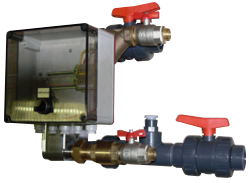

◆ Electrical connections

◆ *Alféa S*

Please refer also to the instructions supplied with pool kit 073958.

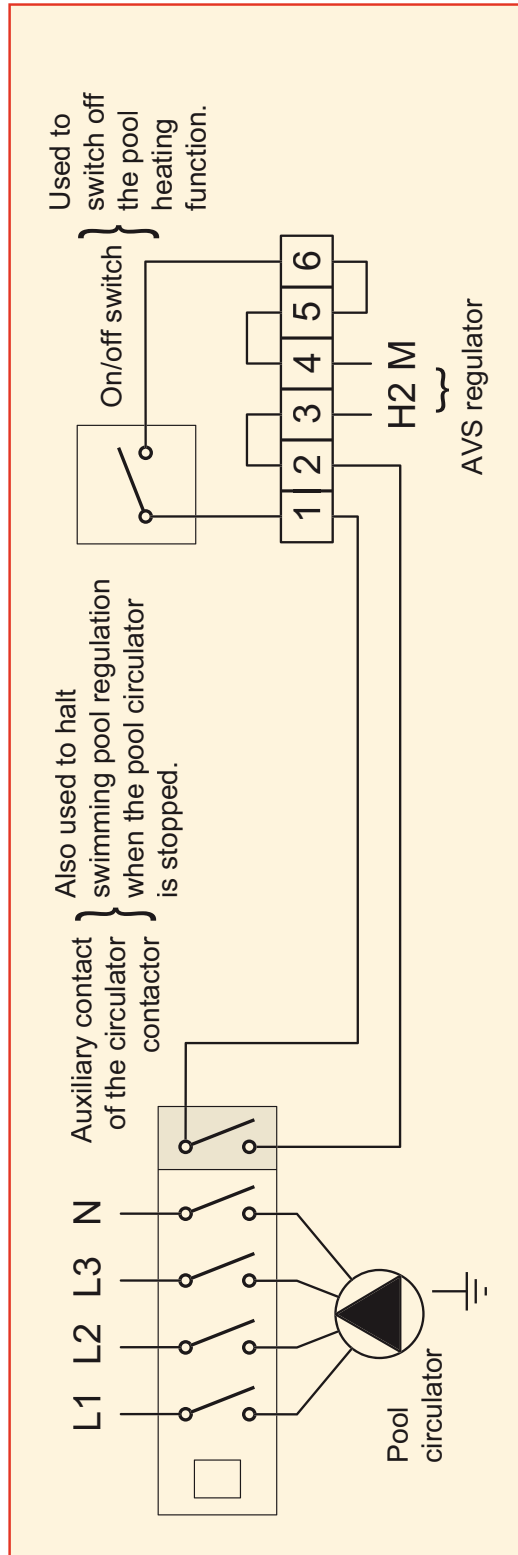

Electrical connections with Alféa S

Société Industrielle
de Chauffage
BP 64 - F59660 Merville

The manufacturer reserves the right to alter its products without prior notice, with a view to continuous rationalisation and improvement of the equipment. Reproduction is forbidden – even partially.