

# FlowCon Pure 316 Stainless Steel 40-50mm

*Automatic Balancing Valve – Pre-Set Built-In Flow-Limiter*



## SPECIFICATIONS

Pressure rating:	3000 kPa at +20°C / 435 psi at +68°F
Temperature rating, media:	0°C to +200°C / +32°F to +392°F +200°C at 660 kPa or lower / +392°F at 95,7 psi or lower
Material:	
- Body:	AISI 316L stainless steel
- Shims:	AISI 316L stainless steel
- Spring:	AISI 316 stainless steel
- Cup:	AISI 316L stainless steel
- Orifice:	AISI 316L stainless steel
- Lock ring:	AISI 316 stainless steel
Pressure range:	100-800 kPaD / 14.5-116 psid
End connections:	Clamp Ferrules sizes: 1 1/2" and 2", fittable for Tri-Clover connections Clamps and gaskets are not supplied by FlowCon

## DIMENSIONS AND WEIGHTS (NOMINAL) (measured in mm unless noted)

Model no.	End connection <sup>1</sup>	D1 (mm)	D2 (mm)	L (mm)	Weight <sup>2</sup> (kgs.)
F494.8.1.xx	1½" clamp ferrules	38.1	50.6	68.0	0.6
F494.8.2.xx	2" clamp ferrules	50.8	63.5	110.0	1.3

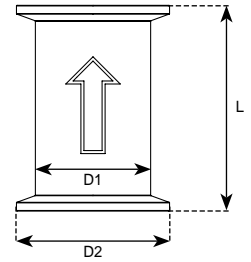

Note 1: Fittable for Tri-Clover connections.

Note 2: Nominal weight, including cartridges and packing material, exact weight is dependent on cartridges.

## MODEL NUMBER SELECTION

F494 . 8 . . . . .

Insert pressure range type:  
8 = 100-800kPaD

Insert size:  
1 = 1½"  
2 = 2"

Insert flow #:  
According to flow rate table below

Example: F494.8.1.06=Mini-Wafer for 1 1/2" clamps with flow rate of 0.493 l/sec.

## FLOW RATE TABLE - STAINLESS STEEL INTERNAL PART - FOR 1 1/2" VALVES

20mm · 3/4" · Stainless Steel Internal Parts - for 1 1/2" valves			
Flow #	Flow (GPM)	Flow (l/hr)	Flow (l/sec)
11	3.30	750	0.208
01	3.90	887	0.246
02	4.40	1000	0.277
03	5.40	1230	0.340
04	6.40	1450	0.403
05	7.00	1600	0.441
06	7.80	1770	0.493
07	8.75	1990	0.553
08	9.60	2180	0.606
10	11.5	2610	0.726
12	13.2	3000	0.833
14	15.1	3430	0.954
16	16.8	3810	1.06

Accuracy: ±10% of controlled flow rate.

## FLOW RATE TABLE - STAINLESS STEEL INTERNAL PART - FOR 2" VALVES

40mm · 1 1/2" · Stainless Steel Internal Parts - for 2" valves			
Flow #	Flow (GPM)	Flow (l/hr)	Flow (l/sec)
09	12.4	2800	0.780
10	13.6	3090	0.859
12	16.1	3660	1.02
14	18.5	4200	1.17
16	20.8	4720	1.31
18	23.0	5240	1.46
20	25.2	5730	1.59
22	27.4	6220	1.73
24	29.4	6690	1.85
26	31.5	7170	1.99
28	33.5	7600	2.12
30	35.5	8060	2.24
32	37.6	8540	2.37
34	39.6	8990	2.50
36	41.7	9460	2.63
38	43.7	9920	2.76
40	45.8	10400	2.89
42	47.8	10900	3.02
44	49.8	11300	3.15

Accuracy: ±10% of controlled flow rate.

## GENERAL SPECIFICATIONS

### 1. AUTOMATIC BALANCING VALVES – FLOWCON MINI-WAFER

- 1.1. Contractor shall install automatic balancing valves where indicated in drawings.
- 1.2. Valve shall consist of a dynamic, flow limiting device.

### 2. VALVE

- 2.1. Valve shall consist of AISI 316/316L Stainless Steel.
- 2.2. Valve housing shall be rated at no less than 3000 kPa (435 psi) static pressure and +200°C (+392°F), but within the below graph.
- 2.3. Valve housing shall be permanently marked to show direction of flow.
- 2.4. Valve housing shall be compatible with Tri-Clover Clamps.

### 3. FLOW REGULATOR / AUTOMATIC BALANCING UNIT

- 3.1. Flow regulation shall be available in 1 kPaD operational range and minimum range shall be capable of being activated by minimum 100 kPaD. The flow regulation shall be capable of controlling flow within  $\pm 10\%$  of rated flow.
- 3.2. Indication tags shall be available for all valves; tags shall be indelibly marked with part number and flow rate.

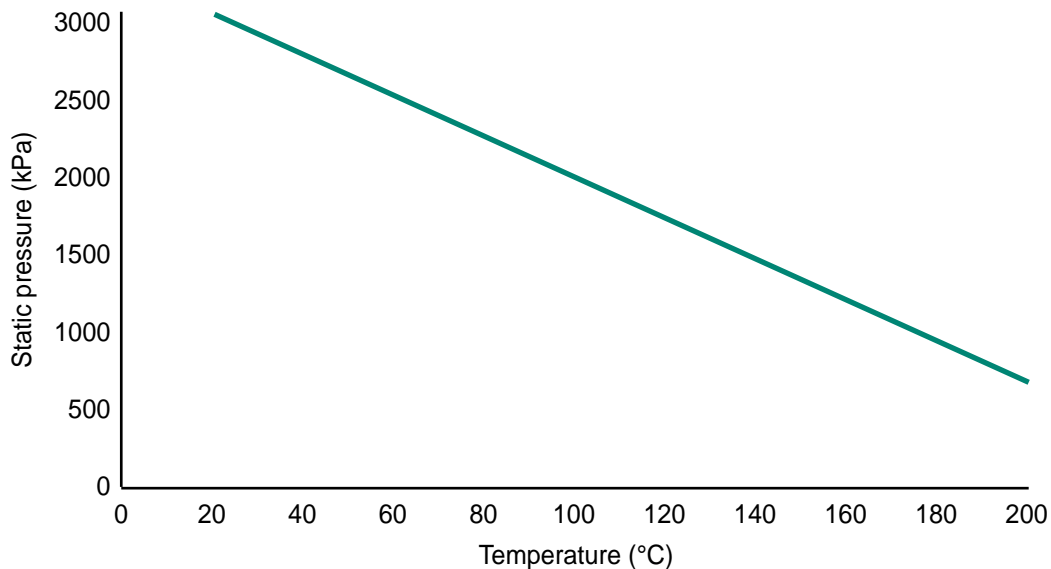

## UPDATES

**For latest updates please see [www . flowcon . com](http://www.flowcon.com)**

FlowCon International A/S can accept no responsibility for possible errors in any printed material.  
All rights reserved.